



Accessibility Guide for Shore Cottage Studio

This guide does not contain personal opinions as to our suitability for those with access needs, but aims to accurately describe the facilities and services that we offer all our guests/visitors.

Introduction

We provide inspirational short courses for artists who may be starting from scratch, or looking to expand their creative practice. Our courses are led by practising artists and are inspired by and rooted in nature. Shore Cottage Studio is uniquely situated on the Wirral peninsula, it has unrivalled views over the tidal Dee Estuary to North Wales. The house and studio are cut off by tides twice a day, and these varying tides, open views, and exposure to the elements make the Cottage and its immediate environment an ever changing, exciting, dynamic, inspirational space.

We run 2-day and 1-day courses in textiles, photography and laser cutting. All materials, tuition, lunch, refreshments and cake are provided. We look forward to welcoming you.

If you have any queries or require any assistance please phone 0151 648 6581 or e-mail studio@ShoreCottageStudio.com.

Pre-Arrival

- Shore Cottage Studio is uniquely situated on the beach at Thurstaston, Wirral.
- All bookings receive a map and directions, sent by post or e-mail before the day.
- If travelling using sat-nav, use directions to Station Road, Thurstaston, Wirral, CH61 0HN
- We have a [Google StreetView-style interactive virtual tour of the inside and outside of our studio building, and the access to it from the beach. Click on this link to view.](#)
- The virtual tour also available at our website: www.ShoreCottageStudio.com/About

- Our grid reference is SJ235835
- 323590X (Easting) and 383503Y (Northing)
- 53.342883 Latitude, -3.1491358 Longitude

- West Kirby is 4.1 miles away, a 10 minute drive - walking via The Wirral Way is 2.7 miles, which takes around 55 minutes.
- West Kirby railway station (CH48 4DZ) is located in the centre of West Kirby - part of the Merseyrail Network, it is the last station of one branch of the Wirral Line.
- Heswall is 3.0 miles away, an 8 minute drive - walking via The Wirral Way is 2.6 miles, which takes around 50 minutes.
- Liverpool is 10.5 miles away, a 33 minute drive via the Birkenhead Tunnel.

- Taxis are available from West Kirby, 4.1 miles / 10 minutes away.
 - Wirral Satellite Cars (0151 201 0001) are next to West Kirby Station, turn left outside the main entrance.
 - Cross Taxis in West Kirby (0151 625 3333) provide accessible vehicles.
-
- Bus users should use Avon Bus Route 82 from West Kirby to Heswall.
 - 44 minutes past the hour, from 08.44 to 18.44.
 - Getting off at Thurstaston Cross.
 - No service on Bank Holidays or Sundays.
 - Thurstaston Cross is approximately 1 mile / 20 minute walk to Shore Cottage Studio.
-
- For further information and timetables visit www.merseytravel.co.uk or phone 0151 236 7676.
-
- West Kirby train station offers cycle hire from Bike & Go. Travelling to Thurstaston from West Kirby train station via The Wirral Way is approximately 2.8 miles and takes around 15 minutes.
 - For full details visit: <http://www.bikeandgo.co.uk/locations/north-west-and-merseyside/west-kirby/>
 - We offer a complimentary ticket policy for carers - non-participating carers may attend and receive drinks, refreshments and lunch. Carers wishing to participate in the course will need to pay, and are advised to book a space at the

same time as the customer - we cannot guarantee that a space will be available after this time.

Car Parking and Arrival

- Parking is available at Wirral Country Park, at the Thurstaston Visitor Centre (for more details go to www.VisitWirral.com or phone on 0151 648 4371). The visitor centre is open dawn until dusk, all year round.
- Shore Cottage Studio is 515 metres / 1690ft / 6 min walk away.
- Parking is available for cars and coaches, 70 spaces in total, 4 of which are Blue Badge spaces. The parking charge is £2 for the whole day.

- Car park is tarmac, with a single pavement (150m/164yds) back to Station Road
- Travel 160m / 175yds along Station Road over a small humpback bridge and down the smooth tarmac road towards a footpath. There is no pavement or street lighting along this section of Station Road.
- Footpath to beach is comprised of earth and gravel, with intermittent handrail for 70m / 76yds.
- Wooden steps backfilled with earth and gravel down to the beach have a handrail on the right hand side for approximately 70m / 230ft. The handrail is then on the left hand side for the remaining 25m / 82ft.
- There are 71 steps in total, the vast majority of which are 10 - 15cm / 4" - 6" inches in height, with 3 steps at around 25cm / 10".
- Shore Cottage Studio is 45m / 148ft from the bottom of the steps, along loose sand and shingle.

- For those with difficulty taking the steps to the beach, we can offer a pickup service by arrangement, travelling from Thurstaston Visitor Centre car park, along Thurstaston Beach to Shore Cottage Studio using a 4-wheel drive vehicle.
- 4-wheel drive is 25m / 82ft from the Studio entrance across grass and is uneven underfoot. The studio is surrounded by a surface of slate chippings, sand and shingle.

Please contact us via e-mail at studio@ShoreCottageStudio.com or phone 0151 648 6581 to discuss details - pickup is subject to tide height and times.

Main Entrance

- Shore Cottage Studio is a single room with reclaimed wooden tile flooring throughout.
- Well lit by several pendant energy saving bulbs.
- The studio space is a single room with no background noise and no background music.
- 2 leather settees are located immediately by the door. Wooden tables are located round the studio (89cm / 35"), which can be stood at to work, and tall stools (620mm / 24.4" and 570mm / 22.4") are available for seating. There is an adjustable soft chair on wheels which can be altered in height (from 410mm / 16.1" up to 570mm / 22.4") - this chair also has a soft backrest.

Hearing Assistance Device

- We have a single Phonak hearing aid device, called a Roger Pen, available in the studio, use of which can be requested when booking.
- A video by Phonak which outlines the uses of the pen device is here: <https://youtu.be/KOJU02GfHIU?t=2m41s>
- The pen is normally worn by our tutor or placed on the table, and features an omni-directional and single direction microphone. This connects to our MyLink device – a receiver that goes round the wearer's neck, either under or over clothing. This can either connect to existing hearing aids using t-coil, or a pair of headphones or earphones can be plugged into it.

Toilets

- Toilet facilities for course participants are located in the main cottage away from the studio.
- The studio door is standard PVC, opening is 870mm / 34.2" wide.
- There are 3 steps down from the studio, a 20m / 65.6ft walk across the garden (sand and slate chippings, grass and stone, can be uneven underfoot).
- Standard PVC door into the house, 700mm / 27.6" opening.
- The cottage has a single level stone floor throughout.
- Height from floor to toilet seat is 430mm / 16.9".
- There is no grab rail or emergency cord.
- Also able to offer a private area in the main cottage for visitors needing privacy for medication / breastfeeding etc.

Catering

- Food and refreshments are served in Shore Cottage Studio.
- Refreshments can be taken at the settees (seats are 400mm / 15.7" high).
- Lunch is served at the main tables (890mm / 35" high) but may be taken at the settees if preferred.
- All teapots and teacups contrast with the tablecloth. Plates have a decorated border in contrast with the tablecloth
- Where possible, all of our food is locally sourced, and all our food served is cooked, baked or prepared on site, on the day of the course.
- Customers with dietary requirements are invited to inform us at the point of booking. A course reminder is sent out a week before the course takes place, when customers are reminded to inform us of any special requirements they may have.
- We have catered for gluten-free, vegan, vegetarian, dairy-free, sugar free and various combinations of these requests.
- We serve a range of hot and cold drinks, and carry a wide selection of herbal teas, decaffeinated tea and coffee.

Grounds and Gardens

- Grounds immediately outside the studio are sand and slate chippings.
- Grass and stone surfaces by the cottage.
- Access from the beach is through a small metal gate and up 6 sandstone steps (step height 210mm / 8.3")
- Bench seating is available at the top of the steps in the cottage grounds and throughout the garden between the beach and the studio.
- A virtual tour of the studio is available at the following link, [which also shows how the grounds are accessed from the beach](#)

On The Beach

- Thurstaston Beach is made up of sand and shingle, with clay cliffs. Care should be taken close to the cliffs as they are unstable.
- Dogs do not have to be a lead on this beach.
- The beach is frequented by walkers, runners, dog walkers and horse riders.
- Wirral Council's Coastal Rangers undertake public guided walks throughout the year. Visit www.wirral.gov.uk for information.
- Free maps and guides for beach walks / access are available from the Thurstaston Visitor Centre.
- Public toilets are located at the Thurstaston Visitor Centre, approximately 270m / 885ft from the beach.

Additional Information

- All staff at Shore Cottage Studio have certified World Host training.
- We welcome trained assistance dogs and will supply fresh water.

Future Plans

- We are currently investigating adding video 'hotspots' to our virtual tour, which will allow visitors to our website to click on various points of the virtual tour to view videos and pages relating to specific areas of our studio. This would include

course videos, sample pieces, equipment details, further information, and artistic techniques.

Floor Plan

- Please visit our website to see a [virtual tour of the inside of the studio](#)
- Measurements and layout are shown in the following images:

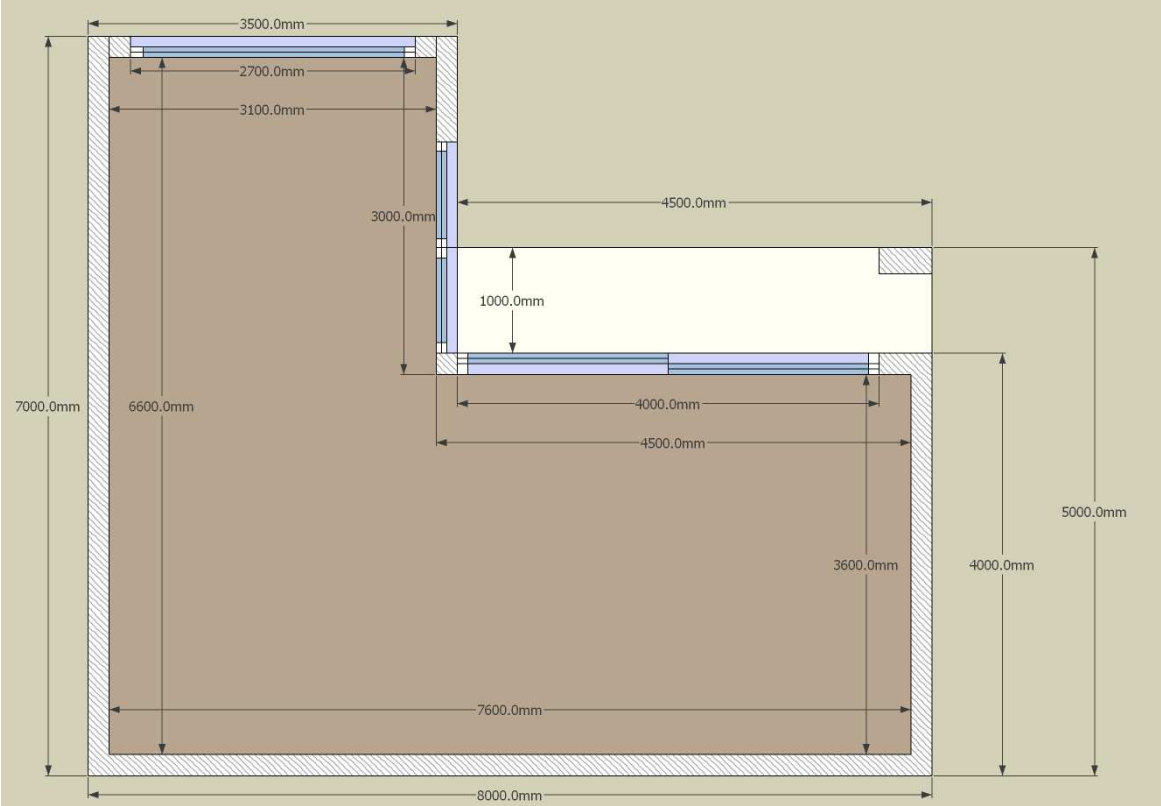

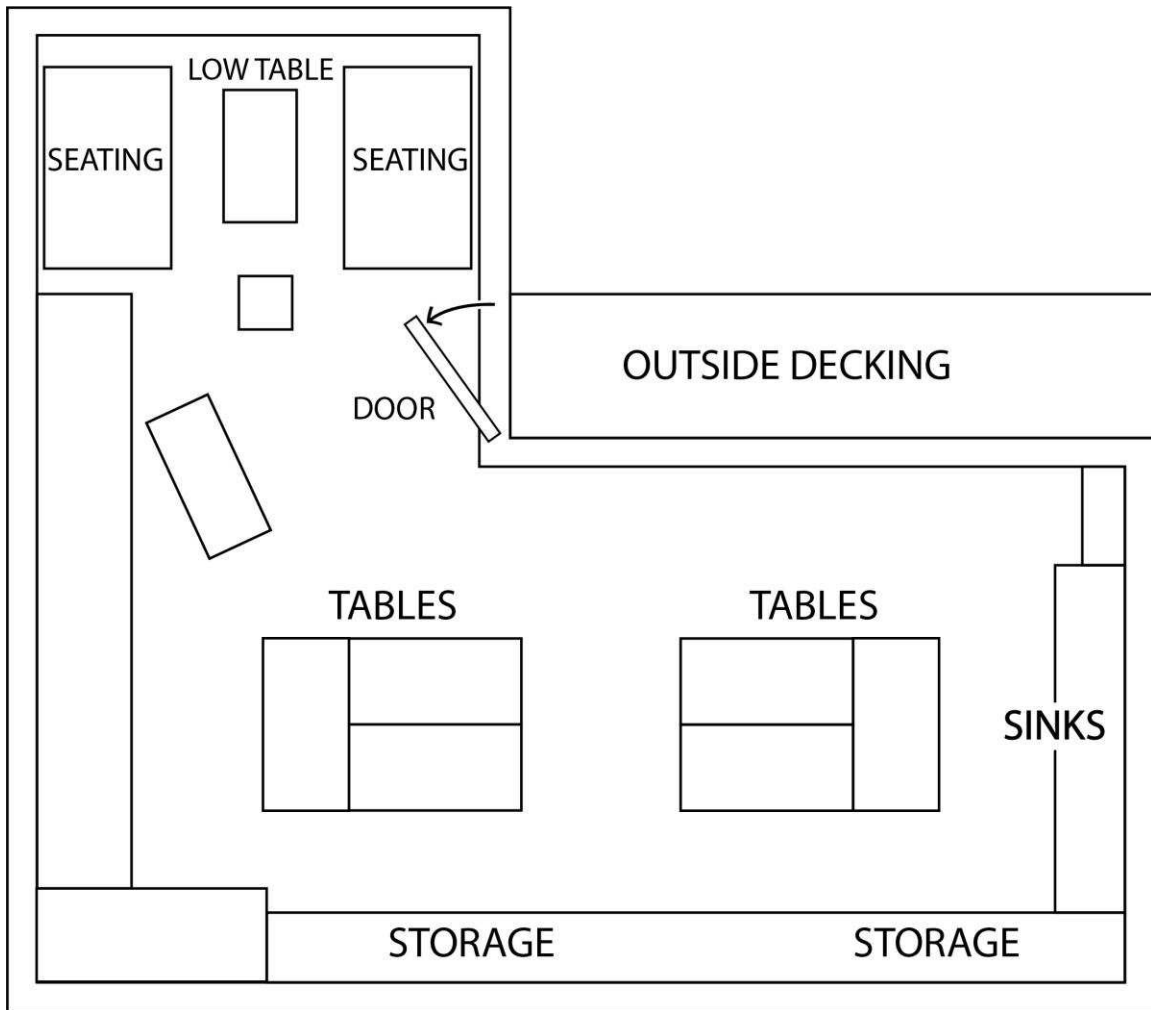

Contact Information

Address (Inc postcode): Shore Cottage Studio Ltd

Station Road

Thurstaston

Wirral

CH61 0HN

Telephone: 0151 648 6581

Email: studio@ShoreCottageStudio.com

Website: www.ShoreCottageStudio.com

Grid Reference: SJ235835

Hours Of Operation: 10am - 4pm

Local Equipment Hire: WIRED: Wirral Information Resource for
Equality and Diversity

5 St John Street, Birkenhead

Wirral, CH41 6HY

Tel: 0151 647 6162

Shopmobility: Liscard Crescent, Wallasey,
Wirral, CH44 1AE

Tel: 0151 606 4665

Warrington Office: 86 Sankey Street,
Warrington, WA1 1SG

Tel: 01925 633492

Freephone: 0800 7316941

www.wired.me.uk/shopmobility.asp

Local Accessible Taxi: Accessible taxis are available from:

Cross Taxis

West Kirby

0151 625 3333

Local Public Transport: Nearest train station is West Kirby, (CH48 4DZ), 4.1 miles away, a 10 minute drive.

West Kirby railway station is located in the centre of West Kirby - part of the Merseyrail Network, it is the last station of one branch of the Wirral Line.

Merseyrail:

<http://www.merseyrail.org>

0151 555 1111

Merseytravel: <http://www.merseytravel.gov.uk>

0151 227 5181

Bike Hire:

West Kirby train station offers cycle hire from Bike & Go. Travelling to Thurstaston from West Kirby train station via The Wirral Way is approximately 2.8 miles and takes around 15 minutes.

For full details visit:

<http://www.bikeandgo.co.uk/locations/north-west-and-merseyside/west-kirby/>